

# Aquastop AR1

Special reinforcing mesh made of alkali-resistant glass fibre.

The use of Aquastop AR1 guarantees the verification of the total weight of the product applied, in order to guarantee that the substrate is totally covered, and acts as a guide for the product's application in order to obtain a waterproofed and even substrate.



1. Superior mesh with Nanoflex No Limits
2. High resistance to the basic environment
3. High shear strength in both directions
4. Without memory effect

# Areas of application

→ Intended use  
Balconies, terraces, flat roofs and external horizontal surfaces in Laminate No Limits systems.

# Instructions for use

→ Application

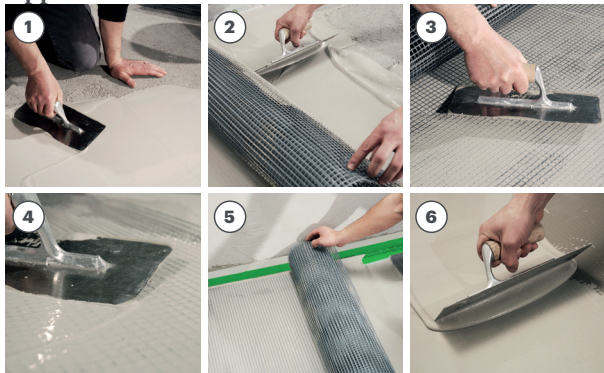

1 Apply Nanoflex No Limits with a smooth spreader in thicknesses of about 1 – 2 mm, pressing down to ensure maximum adhesion to the substrate. The resulting thickness depends on the surface finish and on the irregularity of the substrate.

- 2 Lay Aquastop AR1 on the fresh waterproofing gel membrane overlapping the sheets by about 10 cm.
- 3 Press the Aquastop AR1 down into the first coat of fresh waterproofing, using the spreader.
- 4 Spread out any product coming out of the holes in the mesh for a smooth coat of even thickness.
- 5 Lay Aquastop AR1 on the fresh gel membrane, over the previously laid Aquastop 120 or Aquastop Plus 120.
- 6 Once the product has hardened, and after removing any surface condensation, apply the second coat of Nanoflex No Limits. Lay a continuous, 3mm-thick, even layer, fully covering the Aquastop AR1.

Technical Data compliant with Kerakoll Quality Standard		
Appearance	glass fibre	
Colour	Grey	
Roll width	≈ 1 m	
Roll length	50 m	
Mesh width	≈ 10x10 mm	
Weight of uncoated mesh	≈ 90 g/m² ± 5%	ISO 3374
Weight of primed mesh	≈ 110 g/m² ± 5%	ISO 3374

Performance		
HIGH-TECH		
Final characteristics of the primed mesh:		
- ultimate elongation - warp	average value 1.450 N/5 cm ± 1%	ISO 4606
- ultimate elongation - weft	average value 1.450 N/5 cm ± 1%	ISO 4606

# Warning

- Product for professional use

→ abide by any standards and national regulations

→ the product is an item according to the definitions of the EC Regulation No. 1907/2006 and therefore does not require a Safety Data Sheet
- for any other issues, contact Kerakoll Technical Customer Service: + 39 0536.811.516 [www.kerakoll.com/contatti](http://www.kerakoll.com/contatti)



The Rating classifications refer to the GreenBuilding Rating Manual 2012. This information was last updated in January 2025; please note that additions and/or amendments may be made over time by KERAKOLL SpA; for the latest version, see [www.kerakoll.com](http://www.kerakoll.com). KERAKOLL SpA shall therefore be liable for the validity, accuracy and updating of information provided only when taken directly from its institutional website. The technical data sheet given here is based on our technical and practical knowledge. As it is not possible for us to directly check the conditions in your building site and the execution of the work, this information represents general indications that do not bind Kerakoll in any way. Therefore, it is advisable to perform a preliminary test to verify the suitability of the product for your purposes.